

Instruction

Shield/Visor

1. Open helmet visor, then lift the lower front visor pod cover a little and twist the pod cover up at front as shown.
2. Use a coin to take off screw and washer which hold the visor to helmet.
3. Replace new visor onto helmet using "L" screw washer for left side and "R" screw washer for right side. Match the washer onto visor first then fix the screw with the visor into locating holes on helmet. Finally put the visor pod cover back onto helmet by reversing Step 1, and make sure that you use correct pod covers for each side.

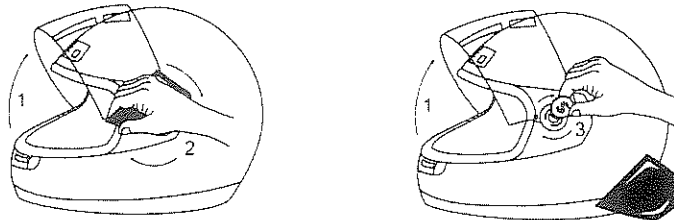

Washable Liner

For your convenience, please follow the instruction as below to place the washable liner.

1. Remove the R/H (1) and L/H (2) inner cheek pads by releasing front velcro and pulling forward. Then remove inside lining as shown (3) by pulling up, starting at neck and working around circumference.
2. Replace liner and cheek pads by reversing step 1, ensuring the 3 pieces are refitted properly.

